

SCALE: 1" = 200'

Staff Exhibit: Staff Recommended Development Area

ORI 2006-00008

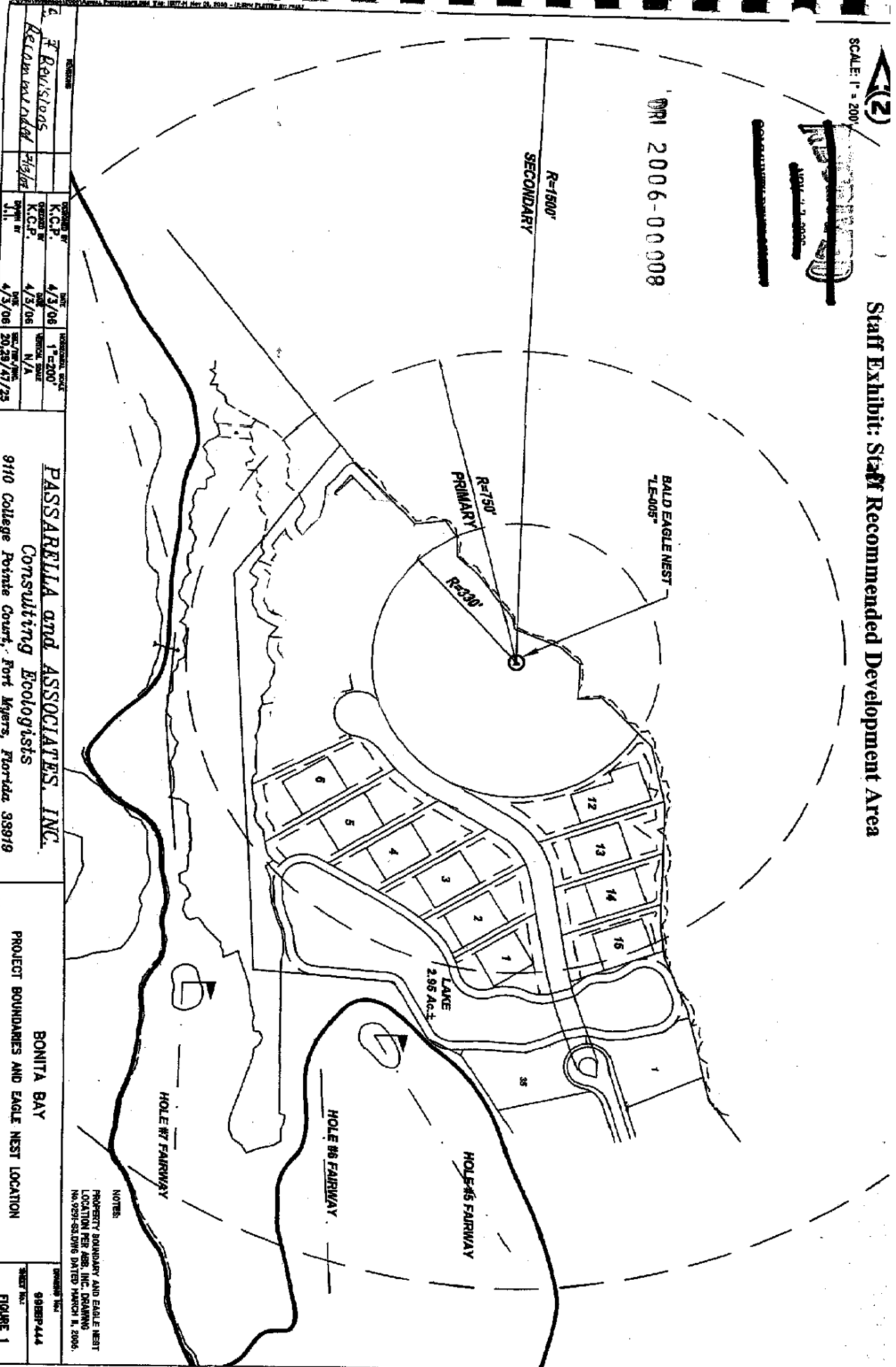

DESIGNED BY <b>T. Revisions</b> <i>Revisions added</i>	DATE 4/3/06	REVISIONS 1" = 200'	DATE 4/3/06	REVISIONS N/A
DESIGNED BY <b>K.C.P.</b>	DATE 4/3/06	REVISIONS N/A	DATE 4/3/06	REVISIONS 20/29/31/25

**PASSARELLA and ASSOCIATES, INC.**  
Consulting Ecologists  
9110 College Pointe Court, Fort Myers, Florida 33919

**BONITA BAY**  
PROJECT BOUNDARIES AND EAGLE NEST LOCATION

DESIGNED BY  
**9888P444**  
SHEET NO.  
**FIGURE 1**

NOTES:  
PROPERTY BOUNDARY AND EAGLE NEST LOCATION PER PAS, INC. DRAWING NO. 9888P-0108 DATED MARCH 11, 2006.

*Ex C*